

MUFFLERS Made of Brass

R3/4

- Made of sintered brass for superior mechanical strength.
- Compact so it requires little installation space.

Symbol



KM-6

Specifications

Item		Model	KM-6
Port size			R3/4
Media			Air
Operating pressure range		MPa [psi]	0~0.9 [0~131]
Proof pressure		MPa [psi]	1.3 [189]
Operating temperature range		°C [°F]	5~60 [41~140]
Material	Body		Brass
	Element		Sintered brass (Porous rating of air pass section: 60 μm)
Effective area		mm ² [Cv]	103 [1900.4]
Noise suppressing effect		dB	15
Mass		g [oz]	150 [5.3]
Sales unit			One pc.

Dimensions mm [in]

●KM-6

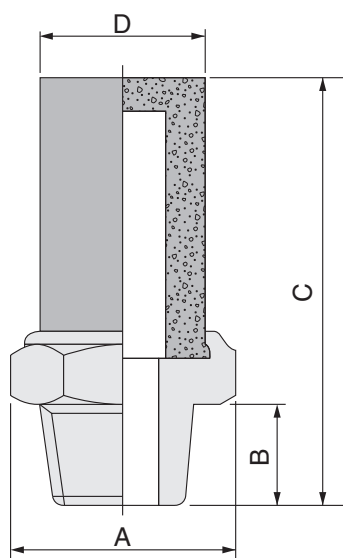

Code Model	Port size R	A (width across flats)	B	C	D
KM-6	3/4	36 [32] [1.417 (1.260)]	15 [0.591]	65 [2.559]	23.5 [0.925]



This muffler is normally used by screwing it into the exhaust port of a valve. Avoid using the muffler where heavy flow impact may occur, such as for the exhaust passing from a quick exhaust valve.