

MUFFLERS Made of Brass

R1/2

- Made of sintered brass for superior mechanical strength.
- Compact so it requires little installation space.

Symbol



KM-4

Specifications

| Item | Model | KM-4 |
|-------------------------------------|---------|---|
| Port size | | R1/2 |
| Media | | Air |
| Operating pressure range MPa [psi] | | 0~0.9 [0~131] |
| Proof pressure MPa [psi] | | 1.3 [189] |
| Operating temperature range °C [°F] | | 5~60 [41~140] |
| Material | Body | Brass |
| | Element | Sintered brass (Porous rating of air pass section: 60 μm) |
| Effective area mm ² [Cv] | | 56 [1033.200] |
| Noise suppressing effect dB | | 8 |
| Mass g [oz] | | 61 [2.152] |
| Sales unit | | One pc. |

Dimensions mm [in]

●KM-4

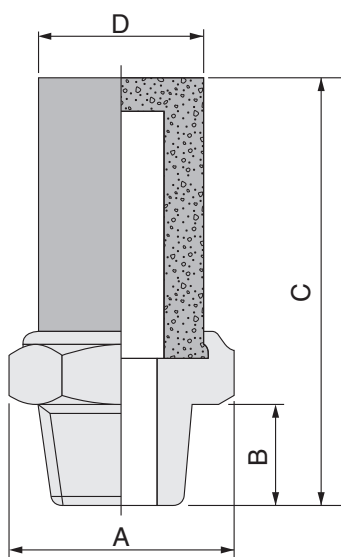

| Code Model | Port size R | A (width across flats) | B | C | D |
|---------------|----------------|---------------------------|------------|------------|--------------|
| KM-4 | 1/2 | 24 (21) [0.945 (0.827)] | 12 [0.472] | 51 [2.008] | 17.5 [0.689] |



This muffler is normally used by screwing it into the exhaust port of a valve. Avoid using the muffler where heavy flow impact may occur, such as for the exhaust passing from a quick exhaust valve.