

MUFFLERS Made of Plastic

R1/4

- Superior noise suppression.
- Low resistance to air flow, so there are no adverse effects on device operations.
- Compact and lightweight for easy installation.
- Long service life. Elements do not corrode for superior moisture and oil resistance.
- Easy to clean with petroleum base products.

Symbol



Specifications

Item		Model	KM-23
Port size			R1/4
Media			Air
Operating pressure range		MPa [psi]	0~0.9 [0~131]
Proof pressure		MPa [psi]	1.1 [160]
Operating temperature range		°C [°F]	5~60 [41~140]
Material	Body		Polyacetal (Duracon)
	Element		Sintered polyethylene (40 μm filtration)
Effective area		mm ² [Cv]	43 [793.350]
Noise suppressing effect		dB	18
Mass		g [oz]	18 [0.635]
Sales unit			One pack (10 pcs.)

Dimensions mm [in]

● KM-23

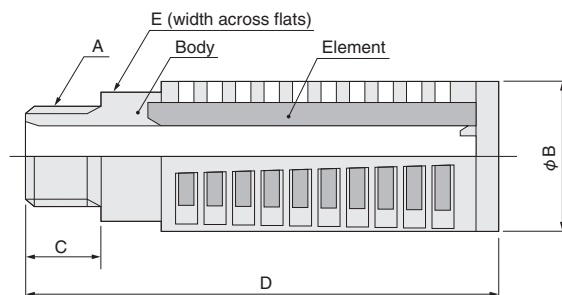

Code	A	B	C	D	E
Model	(R)				(width across flats)
KM-23	1/4	20 [0.787]	10 [0.394]	62.5 [2.461]	17 [0.669]

Handling instructions and precautions

- As the body is made of plastic, do not subject it to excessive force.
- For cleaning, use a neutral detergent or cleaning oil. Do not use thinner, benzene, or other solvents.

● KM-23

Use fingertips to tighten until it stops. Then, use a tool to lightly tighten a little further.