

MUFFLERS Made of Brass

R1/4

- Made of sintered brass for superior mechanical strength.
- Compact so it requires little installation space.

Symbol



KM-2

Specifications

| Item | | Model | KM-2 |
|-----------------------------|---------|----------------------|---|
| Port size | | | R1/4 |
| Media | | | Air |
| Operating pressure range | | MPa [psi] | 0~0.9 [0~131] |
| Proof pressure | | MPa [psi] | 1.3 [189] |
| Operating temperature range | | °C [°F] | 5~60 [41~140] |
| Material | Body | | Brass |
| | Element | | Sintered brass (Porous rating of air pass section: 60 μm) |
| Effective area | | mm ² [Cv] | 42 [774.900] |
| Noise suppressing effect | | dB | 6 |
| Mass | | g [oz] | 53 [1.870] |
| Sales unit | | | One pc. |

Dimensions mm [in]

●KM-2

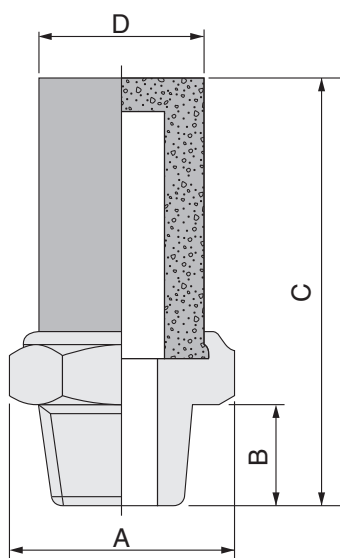

| Code Model | Port size R | A (width across flats) | B | C | D |
|---------------|----------------|---------------------------|------------|------------|--------------|
| KM-2 | 1/4 | 24 (21) [0.945 (0.827)] | 10 [0.394] | 49 [1.929] | 17.5 [0.689] |



This muffler is normally used by screwing it into the exhaust port of a valve. Avoid using the muffler where heavy flow impact may occur, such as for the exhaust passing from a quick exhaust valve.